

## Accessory Installation Instructions

**#WK210 TWO WHEEL KIT WITH 10" TIRES**  
**#WK214 TWO WHEEL KIT WITH 14" TIRES**

Wallenstein portable generators and fits most other makes and models.

### ASSEMBLY AND INSTALLATION INSTRUCTIONS

**NOTICE!**

**If unit has been filled with oil, please do not tip.**

**1:** Assemble sliding axle and install on engine end of unit to place most weight on the wheels. (A, B, C,)

**2:** Block generator until level, and install handle bars to frame as shown in diagram. (E, F, G,)

**3:** Tighten all hardware and check to make sure unit sits level. Adjust if necessary.

**!** Always wear the appropriate safety gear when installing this kit or working around the machine. This includes but is not limited to:

- Hard hat for protection to the head.
- Safety glasses protection for the eyes.
- Heavy gloves for hand protection.
- Safety shoes with slip resistant soles and steel toes.

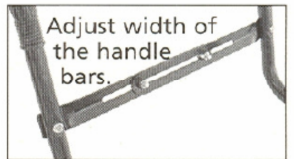
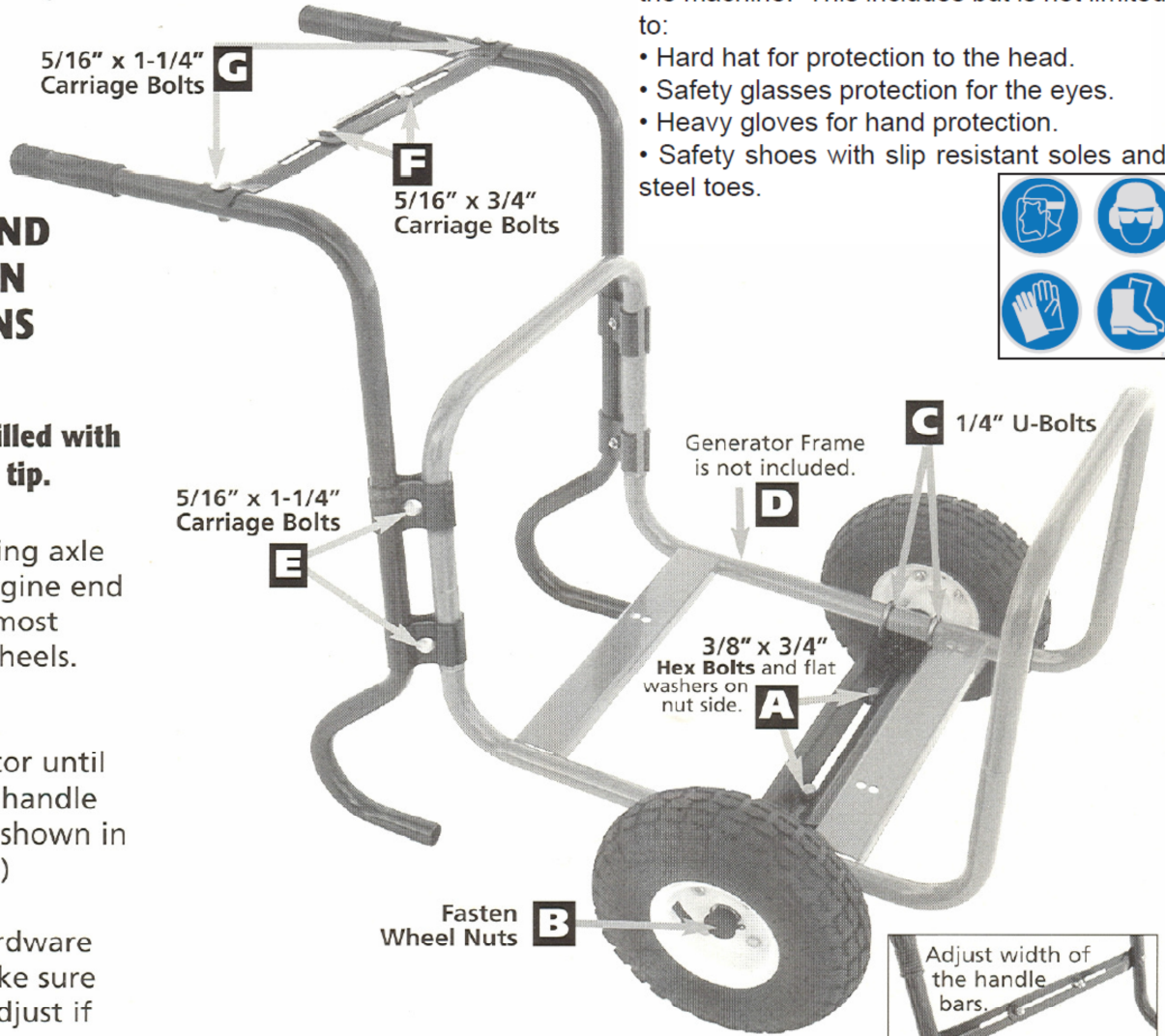

Axle Width Adjustment.

Four U-Bolts with Nuts.

Frame of generator on axle. Place U-Bolts into provided holes.

Fasten each axle side with the U Bolts.

Attach handles to generator frame and adjust heights.

