



# Hannay Reels®

*The reel leader.*

Hannay Reels, Inc., 553 State Route 143  
Westerlo, NY 12193-0159  
Telephone 518-797-3791 • Toll Free 1-877-GO-REELS (467-3357)  
FAX 1-800-REELING (733-5464)  
INT'L FAX (518) 797-3259  
Website: [www.hannay.com](http://www.hannay.com)  
E-mail: [reels@hannay.com](mailto:reels@hannay.com)

## ISO 87 PARTS LIST MODEL GHAT 1200 Portable Hose Reel

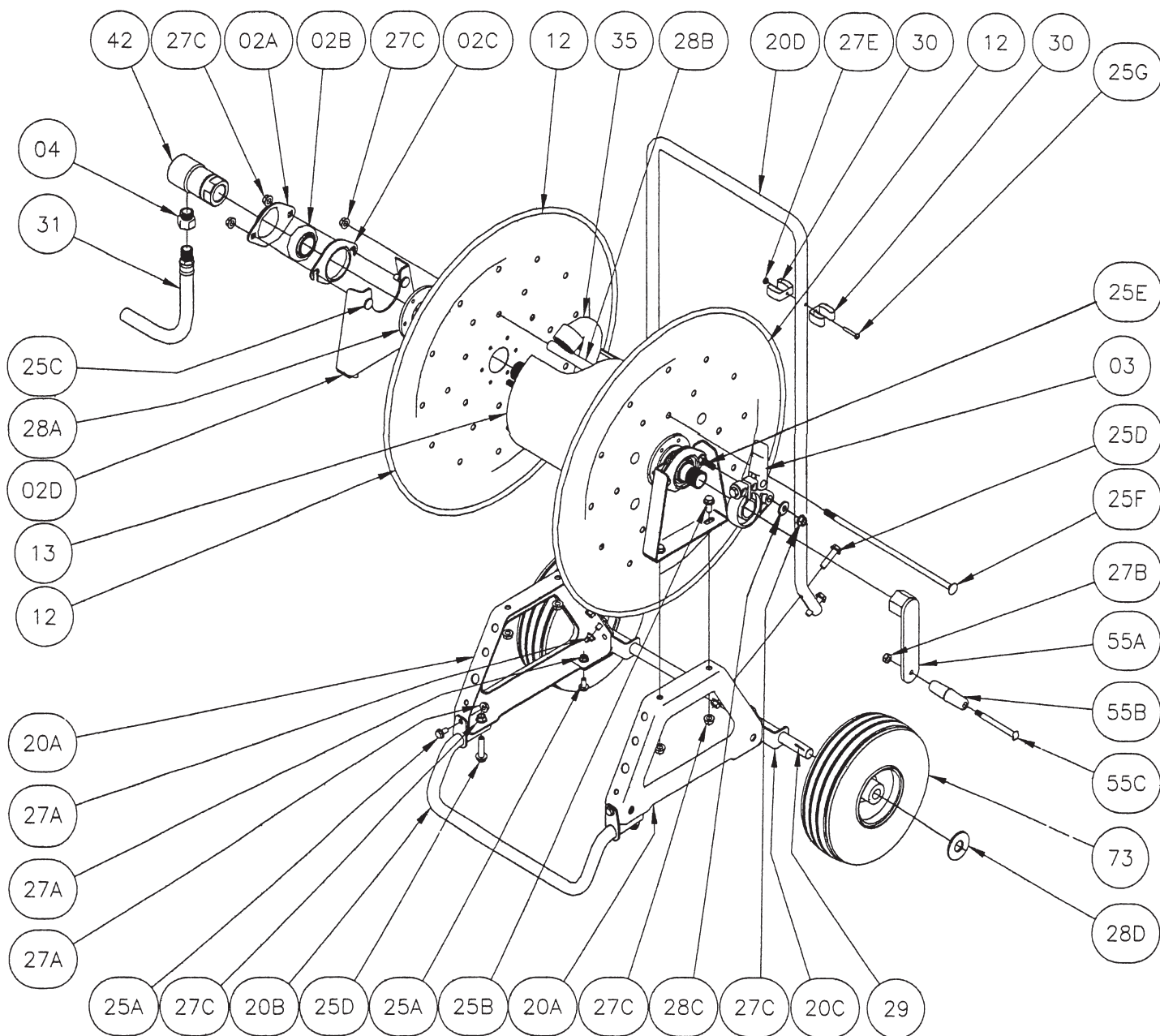

**PARTS LIST**  
**ISO 87**  
**Model GHAT 1200**

When ordering parts

**BE SURE TO SPECIFY COMPLETE MODEL NUMBER and SERIAL NUMBER OF REEL.**  
**USE PART NUMBER!**

<u>Drawing No.</u>	<u>Description</u>	<u><b>PART NUMBER</b></u>	<u>Qty.</u>
2A	Self-Aligning Bearing Holder . . . . .	.9902.2800	2
2B	1" Self-Aligning Bearing Insert Only . . . . .	.9902.1500	2
2C	Self-Aligning Bearing Holder - Slotted . . . . .	.9902.2801	2
2D	Raised Spool Support Bracket . . . . .	.9965.0145	2
3	Cam Lock Brake Complete . . . . .	.9947.0140	1
4	1" MIPT x 3/4" MGHT Adaptor . . . . .	.9950.0001	1
12	23-24 Disc - 22.75" Diameter . . . . .	.9903.1121	2
13	Drum, 8" Dia. (Specify Model) . . . . .	.9905.3121	1
20A	Frame - Steel E-Coated . . . . .	.9906.0011	2
20B	Front Foot . . . . .	.9906.0733	1
20C	Rear Axle Assembly . . . . .	.9906.0732	1
20D	Push Handle . . . . .	.9906.0731	1
25A	5/16"-18 x 5/8" Hex Head Flanged Bolt . . . . .	.9904.1159	6
25B	3/8"-16 x 3/4" Spinlock Bolt . . . . .	.9904.2201	4
25C	3/8"-16 x 3/4" Carriage Bolt . . . . .	.9904.0201	3
25D	3/8"-16 x 1-1/2" Spinlock Bolt . . . . .	.9904.2204	6
25E	3/8"-16 x 2" Carriage Bolt . . . . .	.9904.0206	1
25F	3/8"-16 Carriage Bolt with Nut . . . . .	.9904.0223	6
25G	#10-32 x 1-1/4" Slotted Round Head Screw . . . . .	.9904.8205	1
27A	5/16"-18 Hex Toplock Flanged Nut . . . . .	.9904.5602	6
27B	5/16"-18 Hex Head Nut . . . . .	.9904.5100	1
27C	3/8"-16 Spinlock Nut . . . . .	.9904.6200	20
27E	#10-32 Hex Nut . . . . .	.9904.4900	1
28A	Disc Washer . . . . .	.9965.0015	2
28B	3/8" Spacer Pipe (Specify Model) . . . . .	.9904.3200	6
28C	3/8" Flat Washer . . . . .	.9954.0007	2
28D	3/4" Flat Washer . . . . .	.9954.0010	2
29	1" Cotter Pin . . . . .	.9965.0070	2
30	3/4" Retaining Clip . . . . .	.9965.0055	2
31	5' Lead-In Garden Hose . . . . .	.9965.0060	1
35	1" Welded Iron Pipe Hub Assembly with 3/4" GHT Riser . . . . .	.9901.1700	1
42	Swivel Joint, 1" FxF . . . . .	.9929.8551	1
55A	Hand Crank, Complete with Handle, Bolt & Nut . . . . .	.9914.0041	1
55B	Black Plastic Handle for Crank . . . . .	.9914.0506	1
55C	Bolt with Nut for Black Plastic Handle . . . . .	.9914.0511	1
73	Wheel/Tire . . . . .	.9965.0066	2