

New

Heavy Duty A Frame Hose Reels DHRA50150 & DHRA50300

Buy
now
and
Save!



This Heavy-Duty Hose Reel with Swivel is ruggedly built to withstand heavy use in many industrial applications. The versatile A-frame design mounts on the floor, wall, truck or trailer bed and more. Stainless steel swivel provides extra durability and flexibility.

Choose from two versions one with a capacity of 150 feet of 3/8" hose or one with the capacity of 300 feet of 3/8" hose.

| <u>Inlet/Outlet</u> | <u>Working pressure</u> | <u>Hose ID</u> | <u>Hose Length</u> | <u>Dim W X H X D</u> | <u>Weight</u> |
|---------------------|-------------------------|----------------|--------------------|----------------------|---------------|
| 1/2 " | 5000 PSI | 3/8" | 150 feet | 20" x 18" x 22 3/4" | 30 lbs |
| 1/2 " | 5000 PSI | 3/8" | 300 feet | 27" x 18" x 22" | 32 lbs |

Features

- Versatile A Frame design mounts on floor, wall, truck or trailer
- Stainless steel swivel provides extra durability and flexibility
- Durable one-piece all-welded steel drum (hose not included)
- Hand crank reel features drum pin lock and drag brake
- 300°F max. water temperature
- Rated for 5000 PSI
- 1/2" NPT-F inlet and outlet for higher water flows
- Charcoal gray powder-coated finish

| Item | Part # | Description | QTY |
|------|-----------|-------------------------------|-----|
| 1 | GP2103242 | ASSY, HUB & FLANGE, DHRA50300 | 1 |
| | GP2103247 | ASSY, HUB & FLANGE, DHRA50150 | |
| 2 | GP2103243 | FRAME, HOSE REEL, DHRA50300 | 1 |
| | GP2103248 | FRAME, HOSE REEL, DHRA50150 | |
| 3 | GP2640025 | PILLOW BLOCK | 2 |
| 4 | GP2103244 | ASSY, CRANK | 1 |
| 5 | GP2103245 | ASSY, LOCK PIN | 1 |
| 6 | GP2540087 | BRACKET, BRAKE | 1 |
| 7 | GP2660268 | BRAKE | 1 |
| 8 | GP2200103 | BOLT, M6 | 1 |
| 9 | GP2203018 | NUT, WING, M8 | 1 |
| 10 | GP2200104 | BOLT, M10 | 6 |
| 11 | GP2203017 | NUT, M10, NYLOK, SST | 6 |
| 12 | GP2200013 | WASHER, M8 | 1 |
| 13 | GP2203413 | WASHER, FLAT, M10 | 12 |
| 14 | GP2103246 | SWIVEL | 1 |

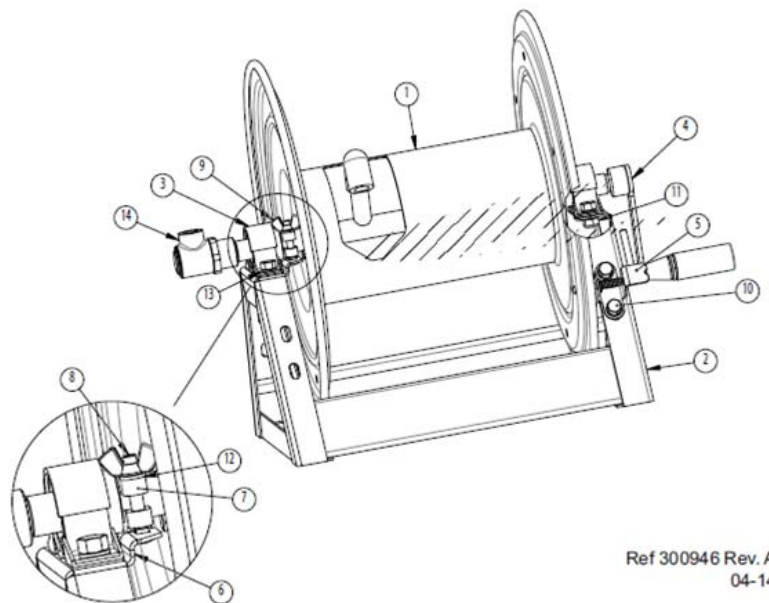

Ref 300946 Rev. A
04-14

